







Bosch Lithium PowerSport Battery:

Innovative lithium iron phosphate technology

The ultra-light Bosch Lithium PowerSport Battery is a real powerhouse. Thanks to its innovative lithium iron phosphate technology it features **1/3** of the weight and up to **10X** the deep-cycle resistance of comparable lead-acid batteries.

The Bosch Lithium PowerSport Battery is suitable for numerous consumers with high energy demands, as well as extremely power-draining situations.



Battery	Bosch Lithium PowerSport Battery
Technology	<p>Lithium Iron Phosphate: no explosive gases, lead or acid; ultra-light, extremely safe, efficient, durable, and quickly recharges in less than 2 hours</p> <p>Charge-status indicator, voltage tester and balancer (passive balancing of battery cells) are integrated into the battery lid – ensuring balanced discharging and quick charging of all cells</p>
Application characteristics	<p>For numerous consumers with high energy demands, as well as extremely power-draining situations such as long off-road journeys and long idle times – ideal e.g., for motorcycles with ABS and ESP (racing, off-road and touring bikes), scooters, dirt bikes, ATV, UTV and jet skis</p> <div style="display: flex; justify-content: space-around; align-items: center;">       </div>
Maintenance	100% maintenance-free
Deep-cycle resistance	Up to 10X higher deep-cycle resistance than conventional lead-acid batteries
Vibration resistance	More vibration resistant than lead-acid
Cold starting power	High starting power, especially suitable for applications with high power consumption
Installation angle	360° / mountable in any position
Self-discharge rate	Very low self-discharge rate – holds its charge up to 4X longer than comparable lead-acid batteries



Lithium Technology (lithium iron phosphate cells)

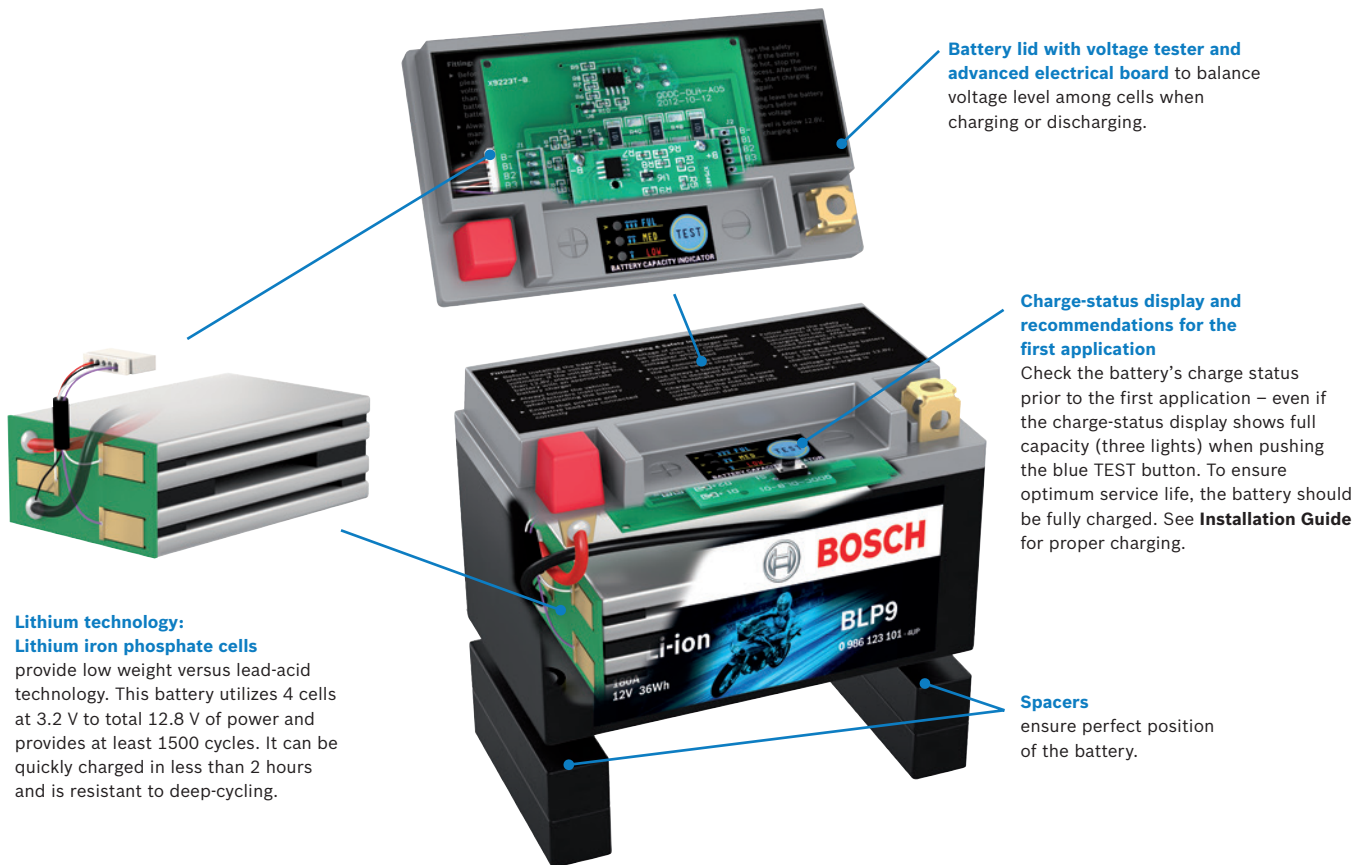

Lithium technology: Lithium iron phosphate cells provide low weight versus lead-acid technology. This battery utilizes 4 cells at 3.2 V to total 12.8 V of power and provides at least 1500 cycles. It can be quickly charged in less than 2 hours and is resistant to deep-cycling.

Battery lid with voltage tester and advanced electrical board to balance voltage level among cells when charging or discharging.

Charge-status display and recommendations for the first application
Check the battery's charge status prior to the first application – even if the charge-status display shows full capacity (three lights) when pushing the blue TEST button. To ensure optimum service life, the battery should be fully charged. See **Installation Guide** for proper charging.

Spacers ensure perfect position of the battery.

Technical data and order numbers

Group Size	References		Order Numbers			Power			Dimensions / Weight			
	JIS Type	BCI Type	Bosch Part Number	10 digits	UPC	CAPACITY (AH)	CA (A)	ENERGY (WH)	WEIGHT (lb)	Length (in)	Width (in)	Height (in)
5S	YTZ5S	BTZ5S	BLP5S	986123100	077212225705	2.0	120	24	1.1	4.45	2.72	3.35
9	YTX9-BS	BTX9-BS	BLP9	986123101	077212225699	3.0	180	36	1.8	5.91	3.43	4.13
14	YTX14-BS	BTX14-BS	BLP14	986123102	077212225682	4.0	240	48	2.0	5.91	3.43	5.63
20L	YTX20L-BS	BTX20L-BS	BLP20L	986123103	077212225675	7.0	420	84	3.5	6.89	3.43	6.10
30L	YIX30L	BTX30L	BLP30L	986123112	077212249893	8.0	480	96	4.5	6.58	4.85	6.42



Scan to view **Lithium PowerSport Battery installation instructions** or visit **BoschAutoParts.com/Powersport/Batteries**.

www.boschautoparts.com